

Stainless Steel Workbench

◆ Product Description

This stainless steel workbench is a J-shaped workbench focusing on the operational demands of large tabletop work. It continues the selection of high-quality materials and practical structural design, with widened operating space, stable performance and abundant functional configurations as its core highlights, and is suitable for scenarios with higher requirements for tabletop area such as mass production and large-scale equipment maintenance.

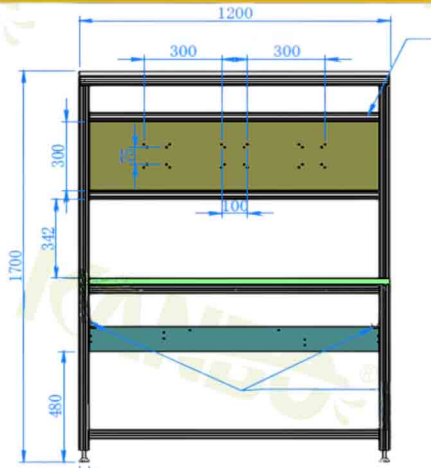

- Premium Material Combination
- Widened Tabletop Design
- Multi-functional & Complete Configuration
- Exquisite Craftsmanship
- Comprehensive Safety Protection

◆ Product Structure

- This stainless steel workbench adopts 40*40 European standard industrial aluminum profiles as the integral frame, with 20*40 aluminum profiles internally clamped with 3MM aluminum alloy panels on the upper and lower sides. the table top is made of T1.2MM 304 stainless steel brushed sheet filled with 25MM wooden boards, and the blank area on the top is a T18MM density board covered with T1.2MM stainless steel sheet. The table top is fixed by drilled holes on aluminum profiles plus self-tapping screws. It is equipped with 4 pcs of 38MM metal foot cups, 5 wire holes, 3 sets of 3-position grounding terminal strips, 2 stainless steel wristband hooks, a black bakelite socket mounting plate and an alarm mounting plate. Lighting lamp holes are reserved on the top, featuring a practical structure.

◆ Typical Applications

- Stainless steel workbenches are widely suitable for various scenarios, including industrial batch assembly, maintenance of large electronic equipment, multi-person collaborative operations in laboratories, vocational skills training, food processing and packaging, as well as the maintenance and servicing of medical devices. They strike an effective balance between operational space, safety, and durability.

◆ Typical Product Data and Physical Properties

Main Frame Material: European Standard Industrial Aluminum Profiles

Auxiliary Frame Material: Aluminum Profiles + Aluminum Alloy Panels

Table Top Material: T1.2MM 304 Stainless Steel Brushed Sheet + T25MM Wooden Board

Overall Dimensions: W1200*D800*H1700MM

Top Auxiliary Structure: T18MM Density Board + T1.2MM Stainless Steel Sheet

Local Functional Structure: T25MM Density Board + Stainless Steel

Support Components: 38MM Metal Foot Cups

Connection Process: Fixed by Screw Installation

Installation Method: Horizontal Placement

Availability:

Item#	Size	Weight
1.4.01.01.0075	W1200*D800*H1700MM	87kg

◆ Technical and Application Assistance

HORB provides a technical hotline to answer your technical and application related questions.

◆ Note:

This information is believed to be accurate. It is intended for professional end users having the skills to evaluate and use the data properly. HORB data for reference only

KANBO is registered trademark of HORB. All rights reserved.